

# IntraPac Plastic Jars

## Specialty Single Wall Jars

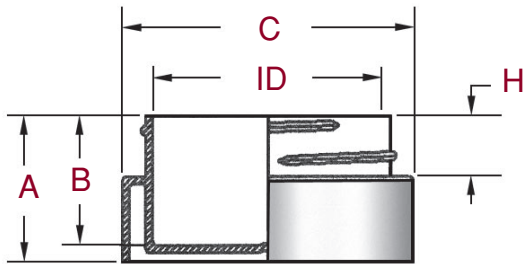

Spacewall Jar

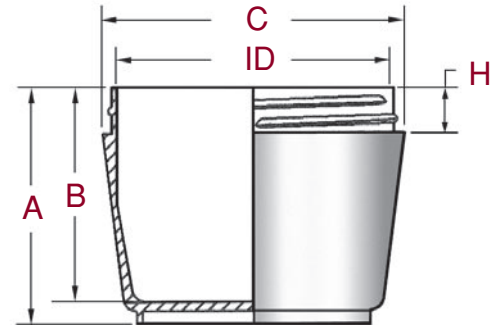

Taper Jar

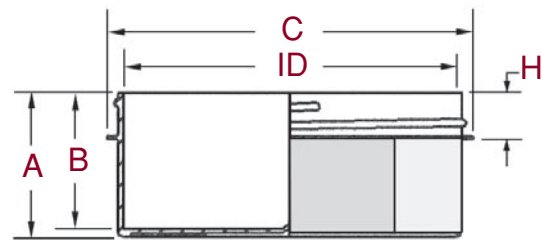

Ten-Sided Jar

IntraPac Specialty Single Wall Jars are offered in the sizes as indicated in the chart. Please refer to both the drawing and chart for specific dimensions for each size.

### Specialty Single Wall Jars

Size	Neck	Material	Gram Wt	OFC	A	B	C	ID	H	*Deco Area	Pcs/Carton
3/8 oz Spacewall	38mm	PP	5.8+/-1.0gr.	14.0+/-1.5cc	.812+/-0.015	.720+/-0.020	1.700+/-0.015	1.250+/-0.015	.390+/-0.015	.25 x 5.25"	1300
1/2 oz Spacewall	38mm	PP	10.0+/-0.5gr.	17.6+/-0.9cc	1.000+/-0.020	.880+/-0.020	1.700+/-0.015	1.250+/-0.015	.408+/-0.015	.37 x 5.25"	1000
2-5/8 oz Ten Sided	70mm	PS	16.0+/-1.0gr.	78.0+/-3.0cc	1.090+/-0.015	.960+/-0.020	2.860+/-0.020	2.484+/-0.015	.385+/-0.015	n/a	350
8 oz Tapered	83mm	PP	35.8+/-1.0gr.	304.0+/-9.2cc	2.820+/-0.015	2.628+/-0.015	3.345+/-0.015	3.045+/-0.015	.480+/-0.015	n/a	144

\* Please contact us on artwork layout.

*IntraPac reserves the right to change or modify the design of its products without any obligation to provide notification of change or intent to change.*

